

**American
School & University**

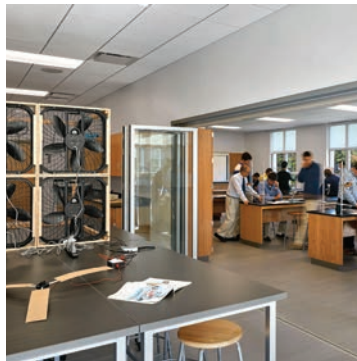
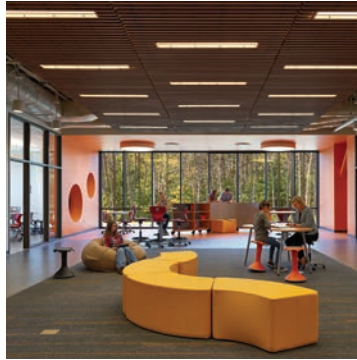
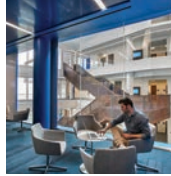

28TH ANNUAL
**EDUCATIONAL
INTERIORS
SHOWCASE**

2018 CALL FOR ENTRIES

STILL ACCEPTING ENTRIES: JUDGING STARTS MAY 2018

SEE INSIDE FOR A FREE PRINT-READY PDF OPTION

See back cover for photo credits.

2018 EDUCATIONAL **INTERIORS** SHOWCASE

The first and most-respected competition honoring education interior design excellence

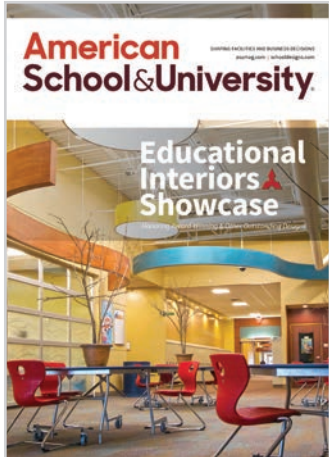

HAVE AN EXCEPTIONAL PROJECT THAT DESERVES NATIONAL RECOGNITION?

Want to showcase your best work to the largest audience? *American School & University's* Educational Interiors Showcase gives your education project a better forum and more national exposure than any other interiors competition. Not just a seasonal magazine, show display, or online list of projects, this special issue is part of a multi-media brand devoted to the best in educational interiors and facility planning.

The August Educational Interiors Showcase issue will put your school or university project in front of decision-makers in the educational facilities market: *American School & University* subscribers and thousands of additional *AS&U* readers who receive the print edition, viewers of the digital edition of the Educational Interiors Showcase, bonus circulation to school boards, and an unlimited audience visiting your project on the industry-leading *SchoolDesigns.com* site. Plus an extended audience at key industry events. See "Who Sees Your Interiors Showcase Project?" in this brochure for more information about *AS&U's* unmatched opportunities for exposure.

Enter any project completed in the past five years in one of twenty-seven interior project categories, from administrative spaces to vocational/industrial-arts areas. The Educational Interiors Showcase is the industry guidebook for administrators planning and designing interior learning environments. It's an investment that pays off.

Enter your outstanding projects today for your chance to receive national recognition for you, your project, and your school or university.

More than half of those who receive an *American School & University* design issue share it - with an average of four colleagues. That means an audience of **more than 182,000** can see your project.¹

Education facility professionals who receive *American School & University* design issues report that they have used them for the following:²

- To **find an architect** or view their work
- To learn about the **latest innovations** in education design
- To **get ideas** for their next project
- To see the **latest educational facilities built** in their region

1. Publisher's Own Data and 2017 Publisher's Survey

2. 2017 Publisher's Survey.

FEATURED CATEGORIES

- Administrative Areas/Offices
- Auditoriums/Music Rooms
- Cafeterias/Food-Service Areas
- Career Centers
- Chapels/Worship Centers
- Classrooms
- Common Areas
- Community Centers/
Joint-Use Facilities
- Conference/Training Centers
- Exhibition Space/Galleries
- Healthcare Facilities/
Teaching Hospitals
- Historic Preservation
- Interior Renovation
(any category)
- Interior Work In Progress
- Laboratories
- Libraries/Media Centers*
- Multipurpose Rooms
- Physical-Education Facilities/
Recreation Centers
- Pre-K/Early-Childhood
Education
- Residence Halls/Lounges
- Service Facilities
- Special-Needs Interiors
- Student Centers/Service Areas
- Technology Centers
- Vocational/Industrial-Arts Areas
- Welcome Centers

*Includes public libraries with an educational component

Architects, schools/universities, interior designers and others related to the field are invited to participate in accordance with the following guidelines:

Entries are accepted for instructional, administrative and service facilities for public, private and parochial schools of all levels, up to and including technical, community/junior colleges, and colleges and universities. **Projects must have been completed after January 1, 2013 or under contract for construction on or before September 1, 2018.**

JUDGING

Each year, AS&U carefully selects an independent jury to represent a mix of school administrators and AIA-member architects. The jury evaluates and selects outstanding projects for publication. Primary consideration will be given to the design firm's solution to the stated educational program requirements. The jury will consider:

- Problem statement and technical specifications
- Architect/Designer response to the program requirements
- Aesthetic characteristics of the solution
- Overall presentation of materials

AWARDS & RECOGNITION

CROW ISLAND (K-12) AND COLLEGIATE AWARDS

The jury will select two Grand Prize winners, one in each of the K-12 and post-secondary categories. Deluxe commemorative plaques featuring the project's pages from the magazine will be presented for both the firm and its client.

CITATIONS

The jury will award Gold, Silver and Bronze Citations to additional projects exhibiting exemplary features. Commemorative Citation plaques will be presented for both the firm and its client.

OUTSTANDING DESIGNS

Projects that exhibit outstanding designs or qualities also will be recognized and selected for publication as Outstanding Designs. These projects are an important part of producing the comprehensive sourcebook for administrators that is the Educational Interiors Showcase. A commemorative plaque will be presented to these firms.



COMPLETE THE ATTACHED ENTRY FORM: ENTER TODAY

Complete an entry form for each project you wish to enter and mail or email to: Molly Roudebush, Senior Marketing Manager, *American School & University*
9800 Metcalf Avenue • Overland Park, KS 66212 • mroudebush@asumag.com

Online entry available at SchoolDesigns.com

Note: Multiple projects from the same firm, or the same project in multiple categories, can be entered and published. Call about special discounts for entering one project in multiple categories. Projects that have been entered in the Architectural Portfolio are eligible for entry in the Educational Interiors Showcase.

UPLOAD PRESENTATION PORTFOLIO: JUDGING STARTS IN MAY

American School & University has a streamlined process to send portfolio materials. When you enter, you receive the link to upload images, description, and project data. Upload all materials from your desktop, using a form that saves your submission as you go. If you are chosen for publication, the materials uploaded will be used to create your page(s) in the magazine. No additional materials will be required.

MATERIALS FOR ENTRY:

PROJECT DESCRIPTION

PROJECT DATA

SPACE PLANS

- One space plan with legend for each floor or area being judged.

IMAGES

- One overall image or rendering that shows the context of the project.
- At least four images or renderings of the project that illustrate various aspects of the entry category.
- If you are entering the Interior Renovation or Historic Preservation category, Before and After images are required.

Projects must have been completed after January 1, 2013

PUBLICATION FEE

If your project is selected for publication in the Educational Interiors Showcase, a fee is incurred to help cover judging expenses, and production, printing and distribution of the magazine. Pay nothing when you enter. If published, you receive an invoice in August.

RATES

- 1 page / \$1,990 **Early-bird offer! Send your entry form by January 16, 2018 to save with a 1-page rate of \$1,750**
- 2 pages / \$1,875 (\$3,750 total)
- 3 pages / \$1,730 (\$5,190 total)
- 4 pages / \$1,620 (\$6,480 total)

Per-page discounts apply to multiple pages for one project, or when entering multiple projects. Call about special discounts for entering one project in multiple categories.

PAGE LAYOUT OPTIONS

Pages	Photographs	Description	Quote From School
1 page	4-5 photos	100-175 words	no
2 pages	8-10 photos	250-300 words	yes
3 pages	12-15 photos	300-400 words	yes
4 pages	15-18 photos	400-450 words	yes

STAND OUT WITH A MULTI-PAGE LAYOUT:

FREE! Print-ready PDF of your layout
More Photos
Larger Photos

Longer Text
Include a Quote from the School/University
Multi-Page Discount

WHO SEES YOUR INTERIORS SHOWCASE PROJECT?

An investment in the Educational Interiors Showcase gives you unmatched opportunities to impact the education facilities marketplace.

THE EDUCATIONAL INTERIORS SHOWCASE ISSUE:

PRINT AND DIGITAL EDITION WITH BONUS CIRCULATION TO SCHOOL BOARDS

57,000¹ subscribers - plus new bonus circulation to school boards - receive *American School & University's* Educational Interiors Showcase. *American School & University* has an engaged community of K-12 and college/university facilities and business professionals and reaches the key decision-making job titles. More than half of those who receive an *American School & University* design issue share it - with an average of four colleagues. That means an audience of more than 182,000 can see your project.²

More than half of those who receive an *American School & University* design issue share it - with an average of four colleagues. That means an audience of **more than 182,000 can see your project.**²

SCHOOLDESIGNS.COM

When your project appears in the Educational Interiors Showcase issue, it is featured on AS&U's SchoolDesigns.com website. The industry's most robust searchable database of school and university projects, SchoolDesigns.com lets an unlimited online audience find and contact your firm and view your projects. No other site compares. Plus, you can link directly to your featured projects from your own website and social media.

AT INDUSTRY EVENTS

The Educational Interiors Showcase will be distributed at industry events the following year, giving your project exposure to key K-12 and college/university facilities and business decision-makers. *American School & University* is now part of Informa, with a network of architecture and design events.

AMERICAN SCHOOL & UNIVERSITY IS NOW PART OF INFORMA, WITH A NETWORK OF ARCHITECTURE AND DESIGN EVENTS.



1. Publisher's Own Data. 2. Publisher's Own Data and 2017 Publisher's Survey

PUBLICITY PACKAGE

SCHOOLDESIGNS.COM

Every project that appears in the 2018 Educational Interiors Showcase will be featured free, including pictures and project description, in the interactive gallery on SchoolDesigns.com — AS&U's industry-leading education design website. We provide a free award icon to link directly to your project from your website or social media.

PLAQUES

Complimentary plaques are provided to all firms chosen for publication.

EXTRA ISSUES

Receive five complimentary issues for each project published in the 2018 AS&U Educational Interiors Showcase.

CONGRATULATORY MAILING

AS&U will mail complimentary copies of the Educational Interiors Showcase to the school/university with a congratulatory letter from AS&U editor-in-chief, Joe Agron.

PRESS RELEASE

A customized press release will be sent to you for distribution to your local newspapers and associations. AS&U distributes a press release to the national media.

FREE DIRECTORY LISTING AND LOGO

Participants in the 2018 Educational Interiors Showcase receive a free listing and firm logo in the "Find A Professional" section of *American School & University's* SchoolDesigns.com site with a link to and from your featured project(s).

BONUS DISTRIBUTION

In addition to reaching subscribers when the August issue of *American School & University* mails, the Educational Interiors Showcase will be distributed at key industry events the following year. AS&U is now part of Informa, with a network of architecture and design events.

EDUCATION BOND ALERTS

Two complimentary months of AS&U's exclusive database of recently passed bond issues.

FREE PRINT-READY PDF!

PRINT YOUR OWN REPRINTS. Receive a free print-ready PDF of your pages from the Educational Interiors Showcase issue when you enter more than one project or for a project with a 2-page layout. Print, post, and give a copy of the PDF to the school/university.

2017 HONOREES

- Architectural Workshop
- Arrowstreet
- ATS&R Architects/Planners/Engineers
- BBS Architects, Landscape Architects & Engineers
- BLGY Architecture
- Buell Kratzer Powell
- CBRE
- Cope Associates, Inc. Architecture
- Cordogan Clark & Associates
- Davis Wince, Ltd. Architecture
- DIGroupArchitecture
- DiMella Shaffer
- DLA Architects, Ltd.
- DLR Group
- Drummey Rosane Anderson
- EwingCole
- Fanning Howey + House Partners
- FKP
- Flansburgh Architects
- Gensler
- GMB Architecture + Engineering
- Harley Ellis Devereaux
- hemmler + camayd architects
- Herrington Architects
- Huckabee
- Hudson Studio Architects, LLP
- Hummel Architects PLLC
- Integrated Architecture
- jBH3 & Associates, Inc. + jBH3 Architects, PC
- Kahler Slater
- Kingscott
- LaBella Associates, DPC
- LAN Associates
- Legat & Kingscott
- Little
- LLB Architects
- MA+ Architecture
- McCarty Holsaple McCarty/Barber McMurry Architects (Joint Venture)
- Moseley Architects
- MSH Architects
- Noelker and Hull Associates, Inc.
- Panzica Building Corporation
- Parkin Architects Limited
- Perkins Eastman
- Quisenberry Arcari Malik, LLC
- Rowland Design
- Schacht Aslani Architects
- Schradergroup Architecture
- SHP Leading Design
- SPM Architects, Inc.
- Stantec
- ThenDesign Architecture
- TMP Architecture, Inc.
- TowerPinkster
- Valerio Dewalt Train Associates
- Wold Architects and Engineers

With an award-winning magazine, websites, newsletters, webinars, research and more, school and university administrators turn to *American School & University* in a rapidly growing and evolving education facilities market. Enter the Educational Interiors Showcase and join industry-leading firms to showcase your project in a multi-media brand that connects with today's education leaders.

**American
School & University**

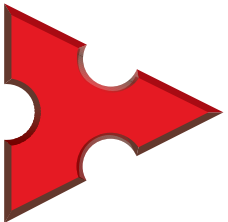

American School & University

Educational Interiors Showcase Entry Form

JUDGING STARTS IN MAY: ENTER ONLINE AT SCHOOLDESIGNS.COM

YES! We would like to participate in the 2018 Educational Interiors Showcase, published in August.

Please reserve _____ full-color page(s) of editorial space for this project.

If selected for publication, we understand that we will be billed for this project as outlined in the "Call for Entries."

Authorized Signature: _____ Date: _____

Purchase Order (if required): _____

PLEASE SEND FUTURE CORRESPONDENCE REGARDING THE 2018 EDUCATIONAL INTERIORS SHOWCASE TO:

Name _____

Mailing Address _____

E-mail Address _____

Phone _____

PLEASE FILL OUT FORM COMPLETELY. (PHOTOCOPY FORM TO SUBMIT ONE APPLICATION FOR EACH PROJECT.)

Name of Project _____

City _____ State _____

Projects must have been completed after January 1, 2013 or under contract for construction on or before September 1, 2018.

PLEASE LIST THE OFFICE/CONTACT THAT COMPLETED THE PROJECT.

Firm _____

Contact Name _____ Title _____

Address _____

City _____ State _____ Zip _____

ENTRY CATEGORY: (select one)

- | | | |
|---|---|---|
| <input type="checkbox"/> Administrative Areas/Offices | <input type="checkbox"/> Healthcare Facilities/Teaching Hospitals | <input type="checkbox"/> Residence Halls/Lounges |
| <input type="checkbox"/> Auditoriums/Music Rooms | <input type="checkbox"/> Historic Preservation | <input type="checkbox"/> Service Facilities |
| <input type="checkbox"/> Cafeterias/Food-Service Areas | <input type="checkbox"/> Interior Renovation | <input type="checkbox"/> Special-Needs Interiors |
| <input type="checkbox"/> Career Centers | <input type="checkbox"/> Interior Work In Progress | <input type="checkbox"/> Student Centers/Service Areas |
| <input type="checkbox"/> Chapels/Worship Centers | <input type="checkbox"/> Laboratories | <input type="checkbox"/> Technology Centers |
| <input type="checkbox"/> Classrooms | <input type="checkbox"/> Libraries/Media Centers* | <input type="checkbox"/> Vocational/Industrial-Arts Areas |
| <input type="checkbox"/> Common Areas | <input type="checkbox"/> Multipurpose Rooms | <input type="checkbox"/> Welcome Centers |
| <input type="checkbox"/> Community Centers/Joint-Use Facilities | <input type="checkbox"/> Physical-Education Facilities/
Recreation Centers | |
| <input type="checkbox"/> Conference/Training Centers | <input type="checkbox"/> Pre-K/Early-Childhood Education | |
| <input type="checkbox"/> Exhibition Space/Galleries | | |

*Includes public libraries with an educational component

What category is right for your project? Contact Molly Roubdebush at 913.967.1959 or mroudebush@asumag.com for assistance and information about special discounts when submitting your project in multiple categories.

COMPLETE ENTRY FORM AND MAIL OR EMAIL TO:

Molly Roubdebush, Senior Marketing Manager
9800 Metcalf Ave. • Overland Park, KS 66212
Phone: 913.967.1959 • mroudebush@asumag.com

**American
School & University**

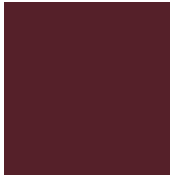

**American
School & University**
9800 Metcalf Avenue
Overland Park, KS 66212-2216

28TH ANNUAL
**EDUCATIONAL
INTERIORS
SHOWCASE**



2018 CALL FOR ENTRIES

ENTER TODAY
JUDGING STARTS MAY 2018

**AMERICAN SCHOOL & UNIVERSITY IS NOW PART OF INFORMA,
WITH A NETWORK OF ARCHITECTURE AND DESIGN EVENTS.**



Front Page (Clockwise from top left): 1. Valerio Dewalt Train Associates; Photo: Justin Maconochie 2. Gensler; Photo: © Garrett Rowland 3. Stantec; Photo: Tom Holdsworth Photography 4. Flansburgh Architects; Photo: Robert Benson Photography 5. Davis Winco, Ltd. Architecture; Photo: Scott Pease Photography 6. TowerPinkster; Photo: Justin Maconochie

This Page (Top to Bottom): 1. DLR Group; Photo: Brandon Stengel, Farm Kid Studios 2. Architectural Workshop; Photo: Ed LaCasse 3. MSH Architects; Photo: MSH Architects, Inc. 4. Stantec; Photo: Luis Ayala